

# HINO

## 500 Series

# FM 2628



\* Illustration may contain items not standard to the model

### ADR 80/03 Model 6 x 4 Cab Chassis

## KEY FEATURES

- Vehicle Stability Control (VSC) with ASR
- Polished Aluminium Wheels
- Cruise Control
- Hino Stop Start System (HSSS) (Manual models only)
- Reverse Camera
- Easy Start (ES) Take off assist (Manual models only)
- Drivers SRS Airbag
- Heated & Electrically Operated External Mirrors
- ISRI 6860/870 Drivers seat with integrated Safety Belt
- ECE R-29 Cab Strength Certified
- Differential Cross Locks

## KEY SPECIFICATIONS

|                                  |  |
|----------------------------------|--|
| <b>GVM.</b>                      | 26,000kg   |
| <b>GCM.</b>                      | .33,000kg Automatic models<br>.38,000kg Manual models          |
| <b>Power</b>                     | .280hp/206kW   |
| <b>Torque</b>                    | .883Nm   |
| <b>Transmissions</b>             | .Nine-speed Synchromesh Manual<br>.Six-speed Allison Automatic |
| <b>Nominal Wheelbases.</b>       | .4.2m, 5.3m, 6.5m  |
| <b>Max. Nominal Body Length#</b> | .5.8m, 7.5m, 9.3m  |

ENGINE

|                               |  |
|-------------------------------|--|
| Model                         | J08E-WA  |
| Max. Output (ISO Net)         | 280hp/206kW @ 2,500 RPM  |
| Max. Torque (ISO Net)         | 883Nm/90kgfm @ 1,500 RPM   |
| Max. Engine Speed             | 2,700 RPM  |
| Engine Compliance             | ADR 80/03 using Euro 5 STD   |
| Type                          | Turbocharged & Intercooled, 6 cylinder in-line, overhead camshaft & fluid cooled     |
| Combustion System             | Direct Injection   |
| Bore & Stroke                 | 112 x 130mm  |
| Piston Displacement           | 7.687L   |
| Compression Ratio             | 18.0:1   |
| Engine Oil Capacity           | 13.5L  |
| Coolant Fluid Capacity        | Auto: 25L<br>Manual: 21.5L   |
| Fuel Injection System         | Electronic control common-rail type  |
| Air Intake System             | Stack-type   |
| Air Cleaner                   | Dual paper elements  |
| Air Compressor                | Single cylinder, fluid cooled<br>85 x 60mm (except XXL Leaf)<br>85 x 40mm (XXL Leaf) |
| Fan Clutch                    | Equipped   |
| Exhaust                       | Horizontal   |
| Emission Control System       | Selective Catalytic Reduction (SCR)  |
| Hino Stop Start System (HSSS) | Manual models only   |
| Engine Immobilizer            | Equipped   |

CLUTCH (MANUAL MODELS ONLY)

|                         |                                      |
|-------------------------|--------------------------------------|
| Model                   | CS-380                               |
| Type                    | Dry single plate with damper springs |
| Facing material         | Organic                              |
| Facing outside diameter | 380mm                                |
| Control                 | Hydraulic with air booster           |

TRANSMISSION & GEAR RATIOS

| Make & Description       | Automatic   |       | Manual                                   |        |
|--------------------------|---|-------|--|--------|
|                          | Allison 3500 series 6 speed with Electronic Control |       | Eaton ES11109 9 speed with Cable Control |        |
| Type                     | Double Overdrive                                    |       | Direct Drive                             |        |
| Gear Ratios              | 1   | 4.593 | 1  | 12.637 |
|                          | 2   | 2.257 | 2  | 8.806  |
|                          | 3   | 1.535 | 3  | 6.550  |
|                          | 4   | 1.000 | 4  | 4.768  |
|                          | 5   | 0.749 | 5  | 3.548  |
|                          | 6   | 0.651 | 6  | 2.481  |
|                          |   |       | 7  | 1.845  |
|                          |   |       | 8  | 1.343  |
|                          |   |       | 9  | 1.000  |
|                          | Rev   | 4.999 | Rev                                      | 13.210 |
| Torque convertor & Ratio | TC 415  | 2.35  |  |        |

PERFORMANCE

|   |           |         |                    |
|---|-----------|---------|--------------------|
| Calculations based on 26.0 t GVM with 11R22.5 drive tyres |           |         |                    |
| Transmission  | Automatic |         | Manual             |
| Wheelbase variants  | Medium    | L & XXL | Medium, Long & XXL |
| Rear Axle Ratio   | 6.142     | 6.428   | 4.625              |
| Engine RPM @ 100 km/h                                     | 2,100     | 2,200   | 2,440              |
| Max theoretical speed (km/h)                              | 128       | 122     | 112                |
| Gradeability tan θ (%) @ GVM                              | 44.9      | 47.5    | 38.2               |
| Speed limited to (km/h)                                   | 100       |         |                    |

BRAKES

|                                 |                                      |
|---------------------------------|--------------------------------------|
| Type                            | Full Air, dual circuit, “S”cam       |
| Drum & Lining sizes             | Front : 410 x 150mm                  |
| Diameter x Width                | Rear : 410 x 220mm                   |
| Auto adjusters                  | Equipped                             |
| Vehicle Stability Control (VSC) | Equipped                             |
| Anti-lock Braking System (ABS)  | Equipped                             |
| Anti-Slip Regulator (ASR)       | Equipped                             |
| Air Dryer                       | Equipped                             |
| Easy Start (ES)                 | Manual models only                   |
| Park Brake                      | Spring Brake acting on FA & FR axles |
| Exhaust Brake                   | Equipped                             |

AXLE, SUSPENSION & LOAD LIMITS

|            |                                      |  |                     |   |                          |
|------------|--------------------------------------|--|---------------------|---|--------------------------|
| FRONT      | Front Axle Model                     | MF 78IR                                  |                     |   |                          |
|            | Type                                 | I-Beam, Reverse Elliot                   |                     |   |                          |
|            | Suspension                           | Taper leaf springs with shock absorbers  |                     |   |                          |
|            | Spring Dimensions                    | 1,700 x 90 x 28.8 mm x 1                 |                     |   |                          |
|            | Length x Width x Thickness x Number  | 1,700 x 70 x 30.3 mm x 1                 |                     |   |                          |
|            | Spring Rate                          | 32.8 kgf/mm                              |                     |   |                          |
|            | Axle Limit<br>(including suspension) | 6,500 kg                                 |                     |   |                          |
|            | Tyre Limit                           | 6,900 kg                                 |                     |   |                          |
| REAR       | Rear Axle Model                      | THD17 & SH17                             |                     |   |                          |
|            | Differential Cross Lock              | Equipped FR & RR                         |                     |   |                          |
|            | Inter-axle Differential Lock         | Equipped                                 |                     |   |                          |
|            | Type                                 | Fully floating, single reduction, hypoid |                     |   |                          |
|            | Rear suspension types                | Hino 6 Rod Leaf                          |                     | Hendrickson Air   |                          |
|            | Suspension                           | Semi-elliptic Multi Leaf                 |                     | HAS 460 airbag with double acting shock absorbers and ECAS remote height control system |                          |
|            |                                      | Medium                                   | Long & XXL          |   |                          |
|            | Spring Dimensions                    | 1,350 x 90 x 20 x 10                     | 1,350 x 90 x 20 x 6 |   | Road Friendly Suspension |
|            | Length x Width x Thickness x Number  |  | 1,350 x 90 x 18 x 3 |   |                          |
|            | Spring Rate                          | 293.4 kgf/mm                             | 234.0 kgf/mm        | Rating N/o 2005   |                          |
|            | Axle Limit<br>(including suspension) | 20,000 kg                                |                     |   |                          |
| Tyre Limit | 21,800 kg                            |  |                     |   |                          |

WHEELS & TYRES

|                    |                                     |
|--------------------|-------------------------------------|
| Material           | Polished Aluminium                  |
| Wheel type         | 10-stud disc (ISO) 335 PCD          |
| Rim size (in)      | 22.5 x 8.25 – 165mm offset          |
| Tyre size          | Front: 295/80R22.5 152/148          |
|                    | Rear: 11R22.5 148/145               |
| Number of tyres    | 11                                  |
| Spare Tyre Carrier | Equipped (except Medium Wheel Base) |

FUEL TANK

|                         |          |                |
|-------------------------|----------|----------------|
| Wheelbases              | Medium   | Long & XXLlong |
| Material                | Steel    | Aluminium      |
| Capacity                | 200L     | 390L           |
| Lockable cap            | Equipped |                |
| Pre Filter & sedimenter | Equipped |                |
| AdBlue® tank capacity   | 59L      |                |

STEERING

|                 |   |
|-----------------|---|
| Type            | Telescopic & tilt steering column with locking device.<br>Recirculating ball with internal Power Steering |
| Steering Angles | Inner 49°   |
|                 | Outer 34°   |

CAB DETAILS

|                                 |  |
|---------------------------------|--|
| Type                            | Forward control, all-steel construction mounted on full floating coil spring suspension with electro hydraulic tilt mechanism        |
| ECE R-29 Cab strength           | Compliant  |
| Drivers SRS Airbag              | Equipped   |
| Seating capacity                | Three  |
| Driver's seat                   | ISRI 6860/870 with urethane foam pads, high-back, lumbar support, multi adjustable, air suspended, with integrated safety belt       |
| Side passenger's seat           | Urethane foam pads, high-back & reclining seat with fabric cover, air suspension   |
| Centre passenger's seat         | Urethane foam pads & foldaway type with seat back tray, fabric cover   |
| Seat belt                       | 3-point type on driver's & side passenger's seat 2-point type on centre passenger seat   |
| Sun visor and overhead console  | For driver & passenger sides   |
| Windshield wipers               | Electric, dual, intermittent & 2-speed   |
| Ventilator                      | Forced type by electric blower   |
| Rear view mirrors               | External: Electric Control & heated flat type, Convex spotters both sides and Left side kerb view                                    |
| 12V/120w Socket                 | Equipped   |
| Floor mat                       | Vinyl type   |
| Central locking & keyless entry | Equipped with immobiliser  |
| Heater and defroster            | Standard   |
| Air conditioner                 | Standard   |
| Trim                            | Full trim type (side, roof & back)   |
| Cab pockets                     | Equipped on both door sides  |
| Power windows                   | Equipped   |
| Rest area                       | Equipped   |
| Multi media system              | 6.5" LCD, HD touch screen display with DAB+ AM/FM radio, AAUX input, Bluetooth® 4.a, Android 6.0 CANBUS connection and Wi-Fi enabled |
| Speakers                        | Driver & passenger   |
| Foot rest                       | Equipped   |
| Easy Start                      | Manual Models only   |
| Cup holders                     | Equipped   |
| Cruise control                  | Equipped   |
| Reverse camera                  | Equipped   |

ELECTRICAL

|                          |                                    |
|--------------------------|------------------------------------|
| Type                     | 24V, negative earth                |
| Batteries                | 12V x 2, series connection, 120 Ah |
| Alternator Type          | Brushless, with built-in regulator |
| Capacity                 | 24V, 90 Amp                        |
| Starter Type             | 24V, 5.0 kW                        |
| Headlamps                | Halogen type with manual levelling |
| High/low beam            | Equipped                           |
| LED Fog Lamps (white)    | Equipped                           |
| Fluorescent Reading Lamp | Equipped                           |
| Electric air horn        | Equipped                           |

POWER & TORQUE CHART (ISO NET) J08E-WA

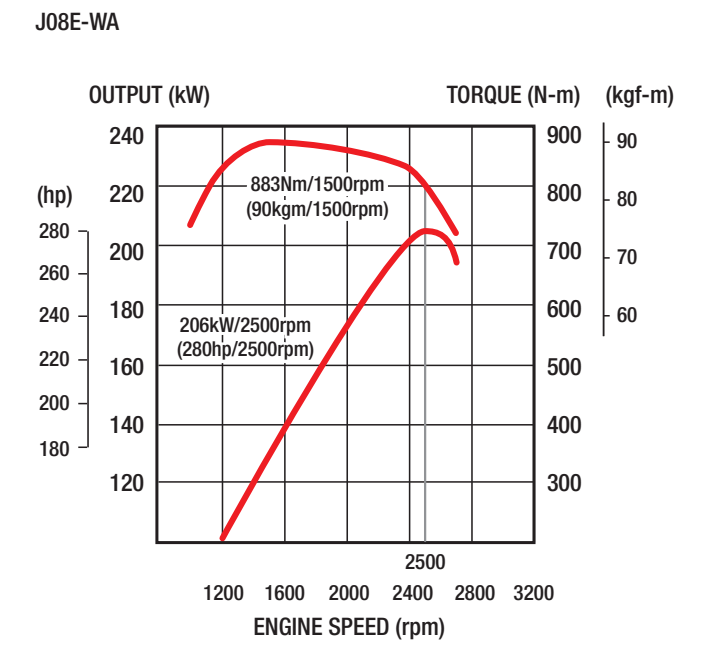

INSTRUMENTS

|  |  |
|--|--|
| <b>Meters</b>                          | <b>Additional Switches &amp; Controls</b>              |
| Speedometer                            | External flat mirror Control                           |
| Tachometer                             | Easy Start Rate Control (Manual models only)           |
| <b>LCD Gauges</b>                      | Idle up Control  |
| Air pressure (2)                       | Quick warm up switch                                   |
| Fuel                                   | VSC/ASR off switch                                     |
| AdBlue®                                | Hino Stop Start System off switch (Manual models only) |
| Engine Temperature                     | Eco Run (Manual models only)                           |
| Odometer plus trip meter               | Headlight Levelling                                    |
| <b>Multi Information Display (MID)</b> | Fog Lamp   |
| Fuel Consumption                       | ECAS remote (air bag models)                           |
| Service reminders                      | Inter-axle & Differential Cross Locks                  |
| Warnings                               |  |
| Faults                                 |  |

CHASSIS FRAME

|  |  |                |
|--|--|----------------|
| Wheelbase variants                               | Medium & Long  | XXLong         |
| Type   | Ladder-shaped channel section side rails with Grid hole design |                |
| Chassis outer width (at rear)                    | 840mm  |                |
| Main section (mm)<br>Depth x flange x Thickness) | 298 x 80 x 7.0   | 300 x 80 x 8.0 |
| Tensile strength                                 | 620 N/mm <sup>2</sup> (63 kgf/mm <sup>2</sup> )                |                |
| Front Underrun Protection (FUP)                  | Equipped   |                |
| Front and rear tow hook                          | Equipped   |                |

GENUINE ACCESSORY OPTIONS

|                 |  |
|-----------------|--|
| Bull bar        | GPS Satellite Navigation               |
| Stoneguard      | External Vision Cameras (additional 3) |
| Sunvisor        | LED Driving Lights                     |
| Seat covers     | Hino Traq (Telematics)                 |
| Floor mats      | Engine driven PTO                      |
| Dash mats       | 1:0.72 step-down                       |
| Weather shields | or 1:1.08 step-up                      |

Please check with your dealer for price, availability & fitment for these options

# FM 2628

**500 Series**

## DIMENSIONS – MM/CAPACITIES

| Model   | FM 2628     |             |             |             |             |             |             |
|---|-------------|-------------|-------------|-------------|-------------|-------------|-------------|
| Wheelbase variant   | MEDIUM      |             | LONG        |             | XX LONG     |             |             |
| Transmission  | AUTO        |             |             |             | AUTO        |             | MANUAL      |
| Rear Suspension   | LEAF        | AIR         | LEAF        | AIR         | LEAF        | AIR         |             |
| Model Code  | FM8JL1M-WHU | FM8JL1U-WHU | FM8JR1A-WHU | FM8JR1G-WHU | FM8JW1A-WHU | FM8JW1G-WHU | FM8JW1G-XHU |
| Wheelbase (WB)  | 4,255       | 4,260       | 5,305       | 5,310       | 6,505       | 6,510       |             |
| Axle Spread (AS)  | 1,350       | 1,330       | 1,350       | 1,330       | 1,350       | 1,330       |             |
| Max Nominal Body length #<br>(WB x 0.6 (up to 3.7)) + CA – 80)                              | 5,773       | 5,781       | 7,578       | 7,586       | 9,295       | 9,300       |             |
| Overall Length (OL)   | 7,845       |             | 9,295       |             | 11,245      |             |             |
| Overall Width (OW)  |             |             |             |             | 2,490       |             |             |
| Overall Height (OH)   | 2,755       |             | 2,750       | 2,755       | 2,750       |             | 2,755       |
| Cab to Rear Axle Centre (CA)  | 3,300       | 3,305       | 4,475       | 4,480       | 5,675       | 5,680       |             |
| Front Overhang (FOH)  |             |             |             | 1,280       |             |             |             |
| Rear Overhang (ROH)   | 2,250       | 2,245       | 2,650       | 2,645       | 3,400       | 3,395       |             |
| Front Chassis Height (FCH)  | 1,030       |             | 1,025       | 1,030       | 1,025       |             | 1,030       |
| Rear Chassis Height (RCH)   | 1,070       | 1,045       | 1,070       | 1,045       | 1,070       | 1,045       |             |
| Road Clearance (RC)   |             |             |             |             | 250         |             |             |
| Front Track (FT)  |             |             |             |             | 2,050       |             |             |
| Rear Track (RT)   | 1,855       | 1,840       | 1,855       | 1,840       | 1,855       | 1,840       |             |
| Turning Circle Kerb to Kerb   | 15,600      | 15,800      | 19,000      |             | 22,600      |             |             |
| Wall to Wall  | 17,200      | 17,400      | 20,600      |             | 24,200      |             |             |
| Indicative Chassis Mass – kg (10 litres of fuel & spare tyre and subject to ± 3% Tolerance) |             |             |             |             |             |             |             |
| Total   | 7,202       | 6,754       | 7,273       | 6,883       | 7,473       | 7,088       | 6,903       |
| Front   | 3,504       | 3,490       | 3,528       | 3,524       | 3,607       | 3,613       | 3,443       |
| Rear  | 3,698       | 3,264       | 3,745       | 3,359       | 3,866       | 3,475       | 3,460       |
| GVM   |             |             |             |             | 26,000      |             |             |
| GCM   |             |             |             |             | 33,000      |             |             |
|   |             |             |             |             | 38,000      |             |             |

# ROH may need to be extended to suit body length and rear overhang is limited to 3.7m

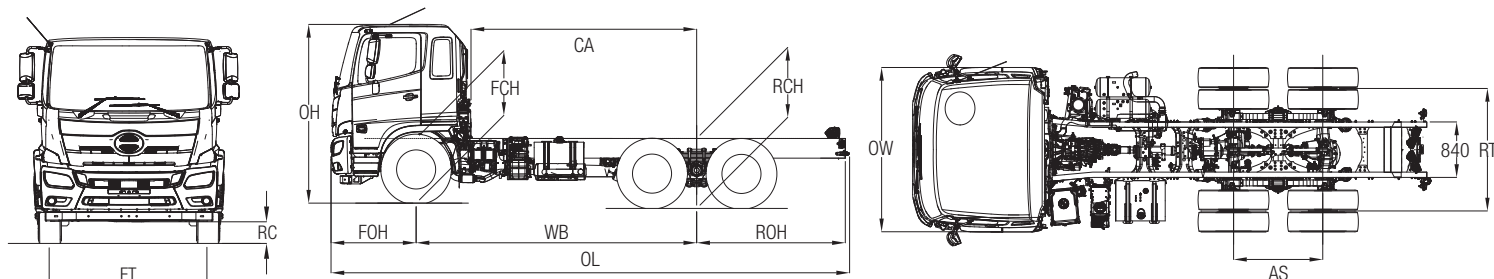

## WARRANTY

New vehicle warranty period

| Medium Duty Model | Axle configuration | Standard warranty<br>(whichever comes first) | Cab corrosion perforation |
|-------------------|--------------------|--|---------------------------|
| 500 FM 2628       | 6 x 4              | 3 years or 200,000km                         | 36 months                 |

Battery warranty – 12 months from date of delivery

Genuine parts or accessories warranty – 3 years unlimited kilometres when fitted by an authorised Hino dealer \*

\* For conditions, refer to the Hino Parts & Service warranty brochure



## DISCLAIMER

Important notice. Hino Trucks are distributed in Australia by Hino Motor Sales Australia Pty Ltd A.C.N. 064 989 724. All efforts have been made to ensure the information contained in this brochure was correct at time of printing or uploading. Hino Motor Sales Australia Pty Ltd reserves the right to alter any details of the specifications & equipment without notice. Hino in so far as it is permitted by law to do so, shall not be liable in any way as a result of any reliance placed by any person on anything contained in this brochure. You should therefore check with your authorised Hino dealer at the time of ordering your motor vehicle to ensure that colour, specifications, equipment, design features & options are available for the vehicle you are ordering. Please note that some options may only be available in combination with others. Authorised Hino dealers will on request provide up to date information on all accessories, design features, prices & availability.